



Meat Showcase KMC Series

KMC-48 | KMC-72

Features

- Black painted steel exterior
- Front-opening curved glass display door(s)
- Equipped with a glass display shelf
- Four (4) caster wheels with adjustable leveling legs
- LED interior lighting
- High quality digital temperature controls
- Bottom-mounted compressor
- Environmentally friendly R290 refrigerant
- Auto condensate evaporator - no drain line needed
- 115V/60Hz/1Ph with 6.5 ft NEMA 5-15 power cord
- ETL approved (conforms to UL-471 and NSF-7)



Nema 5-15P
Dedicated
Circuit

Project Name:	
Location:	
Item:	Qty:
Model:	



3560 NW 56th Street
Fort Lauderdale, FL, United States 33309
Telephone: 786.600.4687 / Toll Free: 844.218.8477
Fax: 786.661.4100

5659 Royalmount Ave.
Montreal, QC, Canada H4P 2P9
Telephone: 514.737.9701 / Toll Free: 888.275.4538
Fax: 514.342.3854 / Toll Free: 877.453.8832
sales@mvpgroupcorp.com / mvpgroupcorp.com

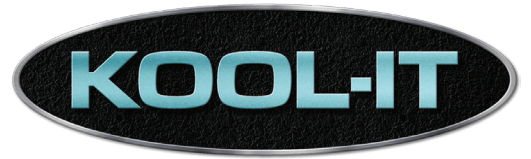

Meat Showcase KMC Series

KMC-48 | KMC-72

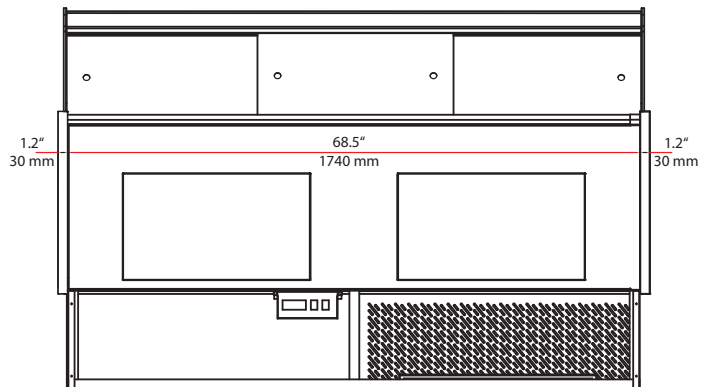
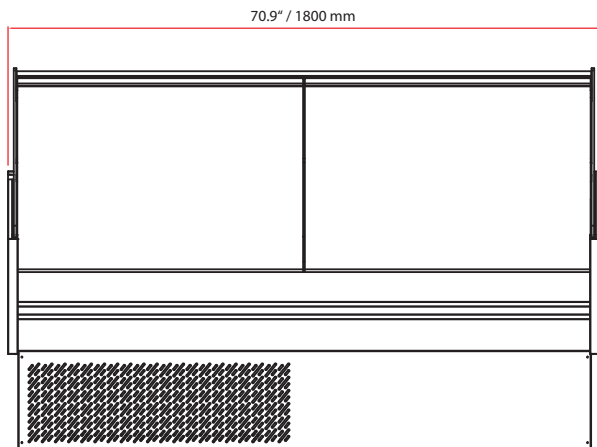
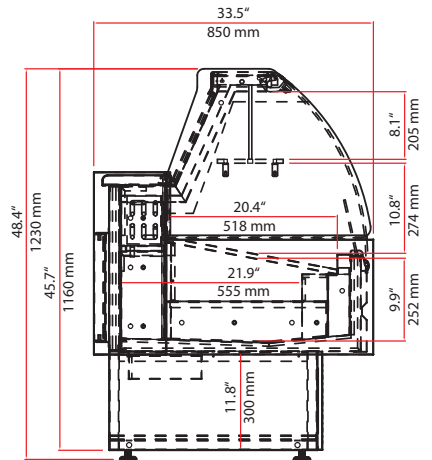
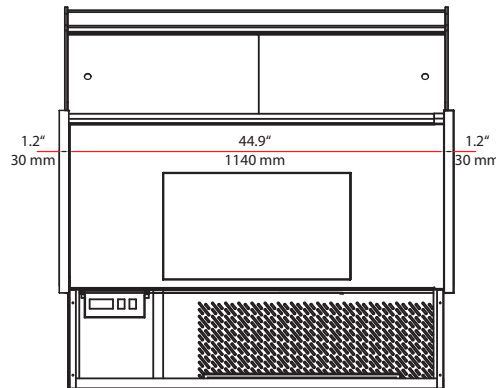
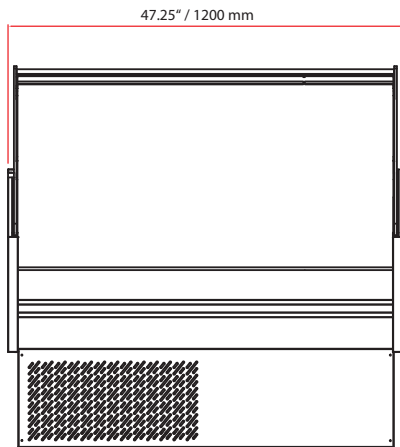

Model	Doors	Display Area	Shelves	V/Hz/Ph	Amps	Refrigerant	Product Dimensions	Shipping Dimensions	Ship Weight
KMC-48	1	6.7 ft ² 0.62 m ²	1	115/60/1	4.9A	R290 4.41 oz	47.25" x 33.5" x 48.4" 1200 x 850 x 1230 mm	52" x 38.7" x 50.3" 1320 x 982 x 1277 mm	370.4 lbs 168 kg
KMC-72	2	10.1 ft ² 0.94 m ²	1	115/60/1	4.9A	R290 4.93 oz	70.9" x 33.5" x 48.4" 1800 x 850 x 1230 mm	75.6" x 38.7" x 50.3" 1920 x 982 x 1277 mm	507.1 lbs 230 kg

The refrigerated KMS series cases are engineered to operate in locations not exceeding 80°F and 55% relative humidity.



3560 NW 56th Street
Fort Lauderdale, FL, United States 33309
Telephone: 786.600.4687 / Toll Free: 844.218.8477
Fax: 786.661.4100

5659 Royalmount Ave.
Montreal, QC, Canada H4P 2P9
Telephone: 514.737.9701 / Toll Free: 888.275.4538
Fax: 514.342.3854 / Toll Free: 877.453.8832
sales@mvpgroupcorp.com / mvpgroupcorp.com